

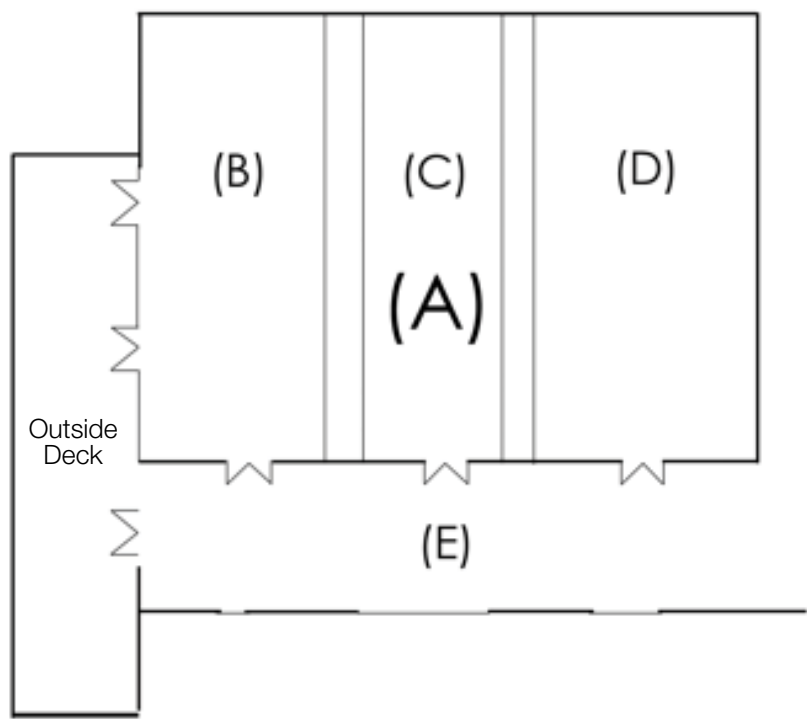

Mountain Ballroom
North Building, Hotel Lobby Level



<i>Meeting Room</i>	<i>Dimensions</i>	<i>Sq Ft</i>	<i>Theatre</i>	<i>Classroom</i>	<i>Banquets</i>	<i>U-Shape</i>	<i>Reception</i>
Mountain Ballroom (A)	60 x 83	4980	450	250	300	-	250
Mountainside (B)	60 x 30	1800	150	80	80	50	-
Evergreen (C)	60 x 23	1380	125	60	60	40	-
Spring Creek (D)	60 x 30	1800	150	80	80	50	-
Pre-Function (E)	20 x 83	1660	-	-	-	-	-